

C-System 400 Industrial, SET

Cartridge Assembly 490 ml, 10:1

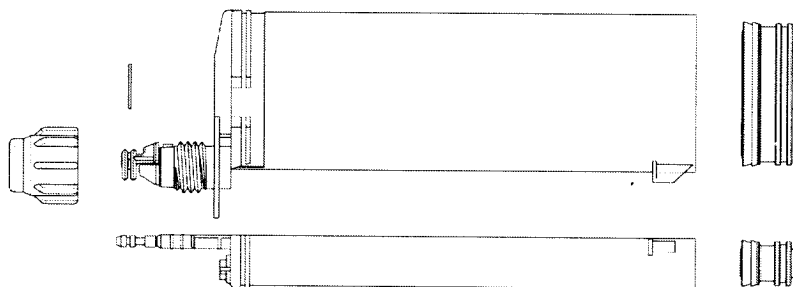

Data is subject to change without prior notice.

Item	Part Number	Description	Material	Parts per Unit (Box)	
Cartridge Assembly	AC 400-10-14-00	Cartridge Assembly 490 ml, 10:1, PP including:		170	
		Cartridge A, 490 ml, 10:1, natural	CA 400-10-14		PP
		Cartridge B, 490 ml, 10:1, natural	CB 400-10-14		PP
		Piston A, 400 ml, 10:1, natural	KA 400-10-11		PP
		Piston B, 400 ml, 10:1, natural	KB 400-10-11		PP
		Nose Plug A, 10:1 green	SA 402-10-23		PE-HD
		Nose Plug B, 10:1 green	SB 402-10-23		PE-HD
		Retaining Nut, natural	UM 13-PP		PP-C
		Removal Disc for Nose Plug	RD 001-00		Steel
Cartridge Assembly	AC 420-10-14-00	Cartridge Assembly 490 ml, 10:1, PP including:		165	
		Cartridge A without Nose, 490 ml, 10:1, natural	CA 410-10-14		PP-C
		Cartridge B, 490 ml, 10:1, natural	CB 400-10-14		PP-C
		Piston A, with Lip, 400 ml, 10:1	KA 400-10-11		PP-C
		Piston B, with Lip, 400 ml, 10:1	KB 400-10-11		PP-C
		Nose Plug A	SA 402-10-23		PE-HD
		Nose Plug B	SB 402-10-23		PE-HD
		Removal Disc	RD 001-00		Steel
		Retaining Nut	UM 13-PP		PP-C
Cartridge Assembly	AC 400-10-18-00	Cartridge Assembly 490 ml, 10:1, PA6 including:		165	
		Cartridge A, 490 ml, 10:1, natural	CA 401-10-18		PA6
		Cartridge B, 490 ml, 10:1, natural	CB 401-10-18		PA6
		Piston A, with Lip, 400 ml, 10:1	KA 400-10-28		PA6
		Piston B, with Lip, 400 ml, 10:1	KB 400-10-28		PA6
		Nose Plug A	SA 402-10-24		PA66
		Nose Plug B	SB 402-10-24		PA66
		Removal Disc	RD 001-00		Steel
		Retaining Nut	UM 13-PP		PP-C